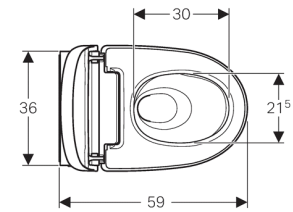
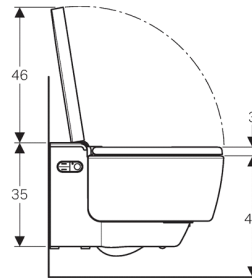
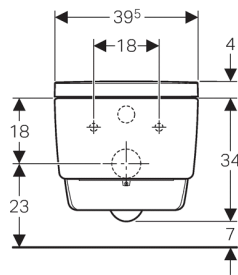

Geberit AquaClean Mera Comfort WC complete solution, wall-hung WC

NEW

Application purposes

- For convenient and odourless toilet use
- For gently cleaning the anal and vaginal areas with water

Characteristics

- Hybrid hot water system with continuous flow heater and storage water heater
- Anal shower with double-nozzle WhirlSpray shower technology
- Separate Lady shower nozzle in protected park position
- Adjustable shower water temperature
- Spray intensity can be set to five different levels
- Spray arm can be set to five different positions
- Adjustable oscillating spray (automatic forward and reverse motion of the spray arm)
- Automatic pre- and post-rinsing of the spray nozzle with fresh water
- Descaling programme
- Rimless WC ceramic appliance featuring TurboFlush flush technology
- Washdown WC with dirt-repellent ceramic surface
- User detection
- Odour extraction with ceramic honey comb filter can be activated
- Odour extraction unit with run-on function
- Dryer can be activated
- Dryer arm can be extended
- Adjustable dryer temperature
- WC seat with rapid heating function
- Adjustable temperature of the WC-seat heating
- WC seat and WC lid with SoftClosing
- WC lid with SoftOpening
- Touchless opening and closing of the WC lid
- Activation of the orientation light when approaching
- Orientation light can be set in seven colours
- Functions and settings via remote control
- Four user profiles can be programmed
- Water supply connection on the left, hidden behind the WC ceramic
- Mains connection with flexible three-wire sheathed cable, on the right side, hidden behind the WC ceramic
- External water supply connection on the left possible with accessories
- External mains connection with power outlet on the right possible
- Pre-mounted sound insulation
- Approval in accordance with (DIN) EN 1717 / (DIN) EN 13077

Technical data

Protection class	I
Protection degree	IPX4
Nominal voltage	230 V AC
Mains frequency	50 Hz
Power consumption	2000 W
Power consumption standby	≤ 0.5 W
Flow pressure	0.5–10 bar
Operating temperature	5–40 °C
Water temperature, adjustment range	34–40 °C
Spray time	30–50 s
Maximum load WC seat	150 kg

Scope of delivery

- Water supply connection set for Geberit Sigma concealed cistern 12 cm and Geberit Omega concealed cistern 12 cm
- Female socket for mains connection
- Spray shield
- Descaling agent, 125 ml
- Cleaning set
- Connection set for WC, ø 90 mm
- Remote control with wall-mounted case and battery CR2032
- Fastening material

Article

Art. no.	Colour	Surface
146.214.11.1	white alpine	
146.214.21.1		bright chrome-plated

i This product is supplied with the Geberit AquaClean descaling agent and the Geberit AquaClean cleaning agent. These consumables contain classified hazardous substances. Information, instructions and measures for handling hazardous substances safely can be found in the appendix or at www.international.geberit.com.

i Available as of April 2017

Accessories

- Wall-mounted control panel for Geberit AquaClean
- Interface module for Geberit Aqua Clean Mera
- Accessory overview: Water supply and electrical connection for Geberit concealed cisterns